

MARCH/APRIL 2005

LA

ARCHITECT

THE MAGAZINE OF DESIGN IN SOUTHERN CALIFORNIA



U.S. \$5.95 / CANADA \$7.95

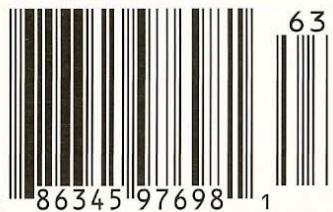

“Tree House”

LOCATION: Anywhere, USA

ARCHITECT: Behnisch, Behnisch & Partner, Inc.

WEBSITE: www.behnisch.com

Of this fanciful, un-built studio space, designer Christof Jantzen says, “It is a contemporary interpretation of a tree house that focuses on the effects of light and openness, rather than on a vernacular use of logs and wood.”

The 600-square-foot rectangular volume, framed in lightweight steel and supported by two concrete columns, is a stand-alone structure, allowing it to float above the landscape. In addition to the insulated glass panels—fastened to a standard aluminum glazing system—that make up the walls, structural glass beams are used to increase the studio’s transparent effect. Sliding glass panels open the interior to an extended deck space. Combined with an existing residence, as it was originally conceived, a connecting entry gallery creates an exterior courtyard shared by house and studio.

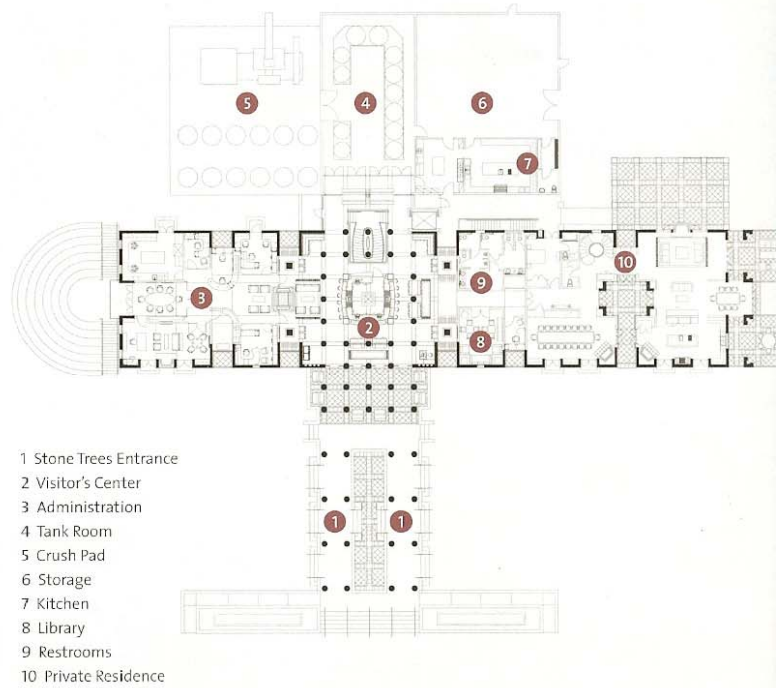

Darioush Winery

LOCATION: Napa, California

ARCHITECT: Nozari + Nozari Architects

WEBSITE: www.nozariarchitects.com

Two major factors determined the form of this Napa Valley winery. The most obvious is the nearly archaeological evocation of the lost city of Persepolis. More subtle is the need to create a sensible experience for the oenophile on tour. As Ardashir Nozari asks, “How do you transition from this vast exterior to an interior [and back]?”

Tour members first gather in a slightly sunken area in front of the building, flanked by lily ponds. Led forward, through column groupings that compress as they near the doors, the group enters into the relatively spacious tasting bar. They then traverse the linear building as it expands and contracts through a series of pavilions joined by glass passages, until they reach the expansive amphitheatre at one end. Circling back around to the front, the walkways are held back from the building so that they can see where they’ve been. Finally, they re-enter to taste.

